

Application:16/04022/FULL1

Address: Studio At Burgh Hill Kingswood Road Shortlands Bromley
BR2 0HQ

Proposal: Conversion of garage and studio below to form new one bedroom unit. Increase in roof height of existing garage, ground floor rear extension and provision of external courtyard area to ground floor. Elevational alterations

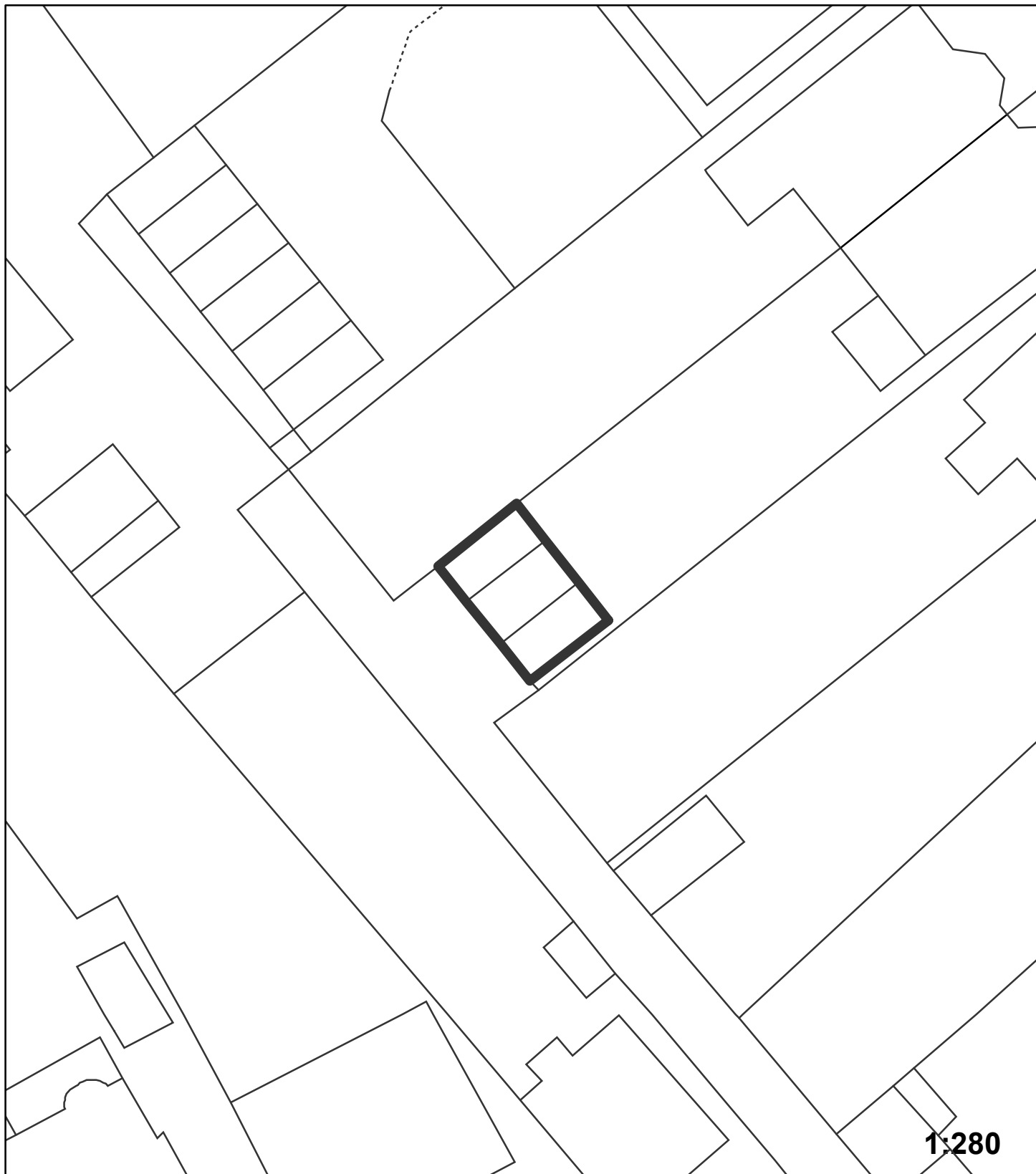

"This plan is provided to identify the location of the site and should not be used to identify the extent of the application site"

© Crown copyright and database rights 2015. Ordnance Survey 100017661.