

Application:16/05881/FULL1

Address: 4 Pleydell Avenue Anerley London SE19 2LP

Proposal: Construction of 2/3 storey 3-bed end of terraced dwelling

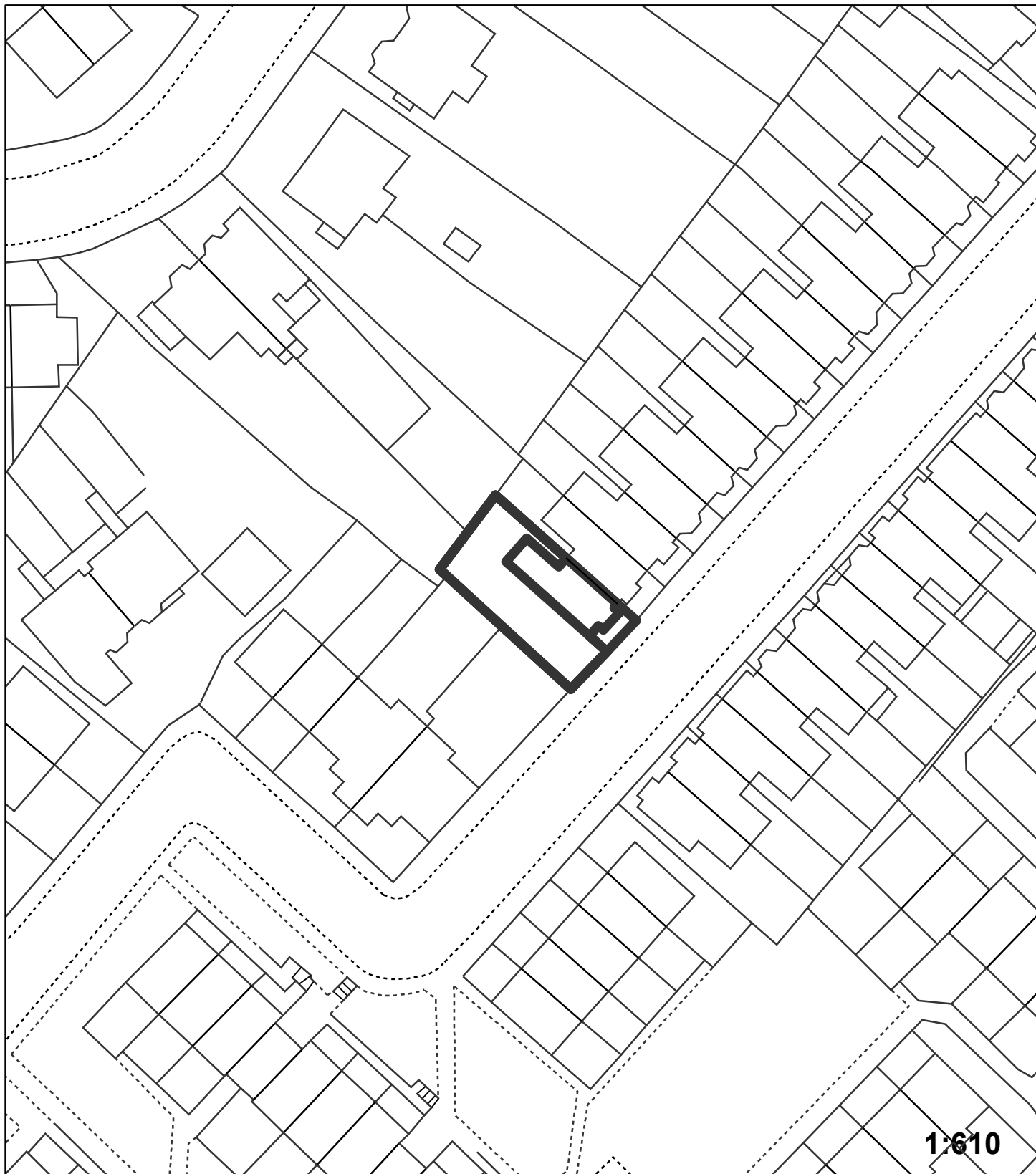

"This plan is provided to identify the location of the site and should not be used to identify the extent of the application site"

© Crown copyright and database rights 2015. Ordnance Survey 100017661.