

Application:17/01072/FULL1

Address: The Elms Westbury Road Beckenham BR3 4DD

Proposal: Demolition of existing building and construction of a 2.5 storey terrace style building comprising 3 one bedroom flats and 6 two bedroom duplex residential units along with associated landscaping, 9 car parking spaces, refuse and cycle storage.

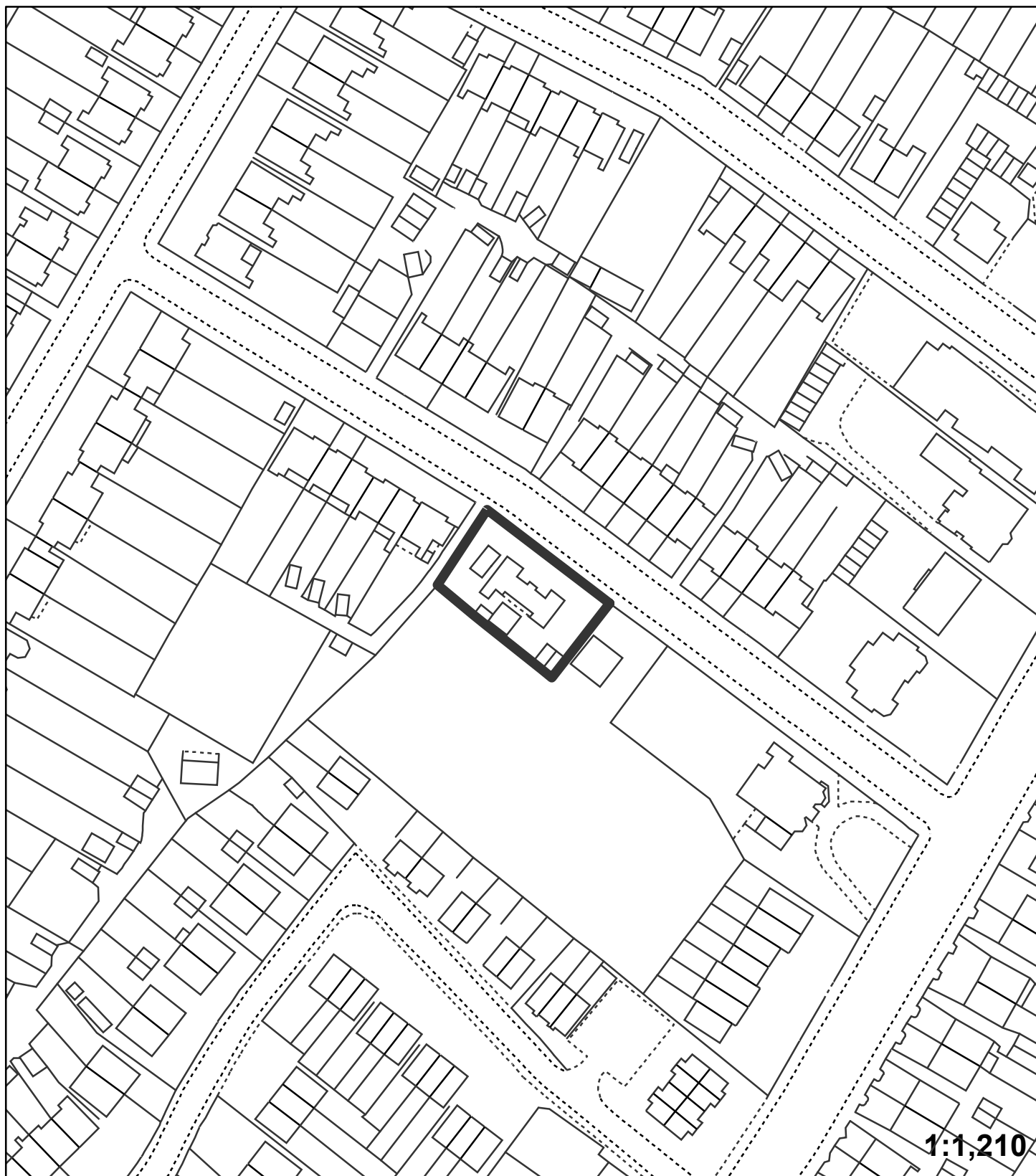

"This plan is provided to identify the location of the site and should not be used to identify the extent of the application site"

© Crown copyright and database rights 2015. Ordnance Survey 100017661.